

Notes: - Advanced D.C. Motors, Inc. retains all proprietary rights in the information disclosed on this drawing. It is issued in confidence for engineering information only and may not be used, in whole or in part, in manufacture, copying, alteration or not shown version, reproduction or disclosure in any way without direct written permission from Advanced D.C. Motors, Inc.

Advanced D.C. Motors, Inc. Syracuse N.Y. U.S.A.	
PART NO.	PART NO.
A00-4009	A00-4009
VOLT D.C.	CLASS H
36	SERIAL NO.
RATING	2300 RPM 4.15 HP CONT

- \* NAME LABEL STAMPED WITH CUSTOMER PART No, ADVANCED D.C. MOTORS PART No A00-4009 AND 36 VOLT
- \* "2300 RPM 4.15 HP CONT" STAMPED ON NAME LABEL IN RATING BOX
- \* CODE DATE STAMPED ON FRAME NEAR NAME LABEL

OUTLINE DIMENSIONS ARE NOMINAL UNLESS TOLERANCES ARE SPECIFIED

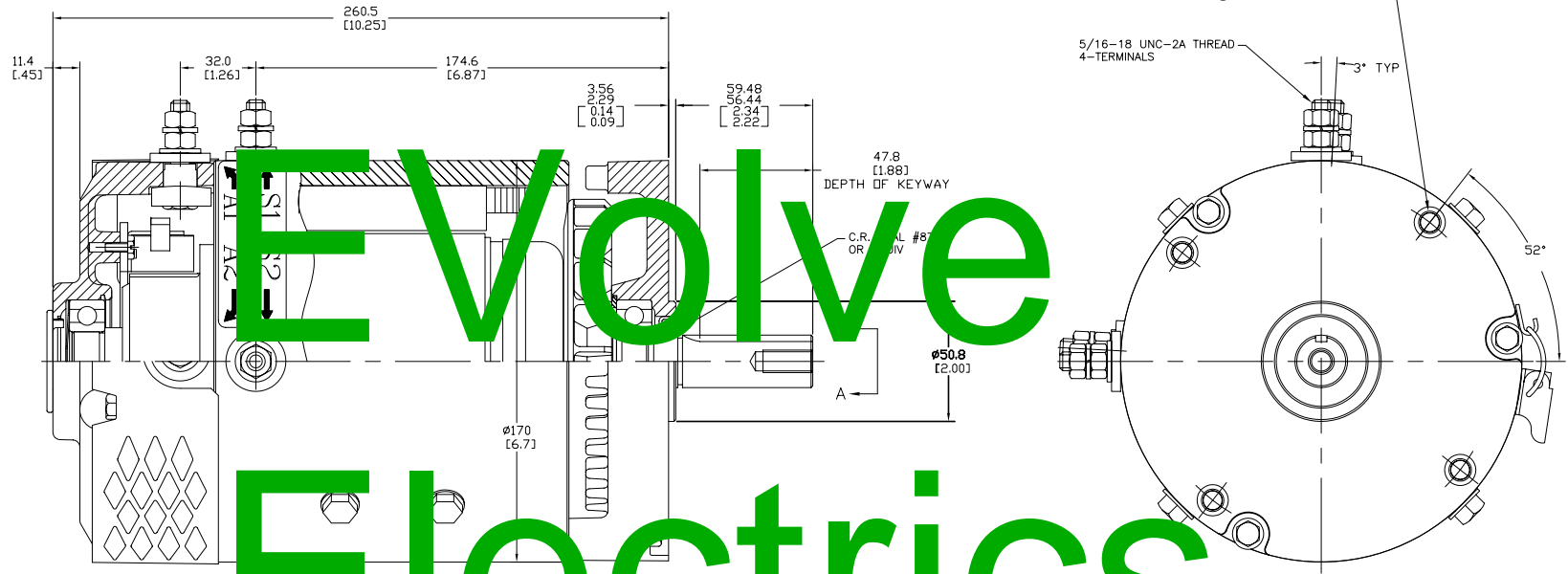

3/8-16 UNC-2B x 15.7/.62 DP MIN THREAD  
MIN WITH A 12.7/.50 DIA. x 120°  
C'SINK 4-HOLES EQUALLY SPACED ON A  
149.23±0.20/5.875±.008 DIA B.C.

5/16-18 UNC-2A THREAD  
4-TERMINALS

# Evolve Electrics

TEST TO CURVE:

CLASS "B" INSULATION

- \* FRAME - PAINT
- \* END HEADS - NATURAL ALUMINUM
- \* HEADBAND MATERIAL: ALUMINUM
- \* VENTILATED MOTOR WITH FAN
- \* MOTOR WEIGHT: 21 KG / 46 LBS
- \* THIS MOTOR IS A REPLACEMENT FOR A89-4001

36 VOLT

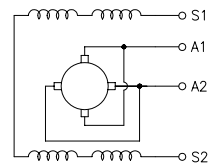

WIRING DIAGRAM

ROTATION - REVERSIBLE

C.W.D.E.  
CONNECT S1 TO ONE BATTERY TERMINAL  
CONNECT S2 & A1  
CONNECT A2 TO OTHER BATTERY TERMINAL

C.C.W.D.E.  
CONNECT S1 TO ONE BATTERY TERMINAL  
CONNECT S2 & A2  
CONNECT A1 TO OTHER BATTERY TERMINAL

3/8-16 UNC-2B x 21 ±.8/.83 ±.03 DP THD  
WITH A .8/.03 x 45° CHAMFER

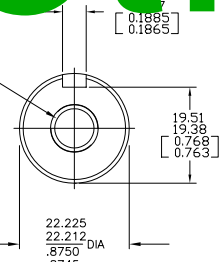

VIEW A-A  
SCALE: 2:1

Zone Rev		Was		By		Date		MILLIMETER / INCHES OR MILLIMETER INCHES		PROJECTION THIRD ANGLE		Material Ref A89-4001 This print is the property of Advanced D.C. Motors, Inc. and supersedes all prints previous to last revision. Do not scale-work to dimensions.		Advanced D.C. Motors, Inc. Syracuse N.Y.	
D		CORRECT HOLE SIZE, POR 4150		SMR 10/25/02		MUG 06-14-02		Scale		Drawn		Date			
D		REDRAWN IN ACAD, LAST REV C						FULL		PJB		01-26-00			
								Part No				A00-4009			

LO-219

XP-11646